



WAREHOUSING & DISTRIBUTION OPPORTUNITIES IN CENTRAL DE

Here are some of the Properties Central Delaware has available for your business



DOVER - 12 ac,
39,000 sf Warehouse



HARRINGTON - 130 ac
Bldg 100,000 sf

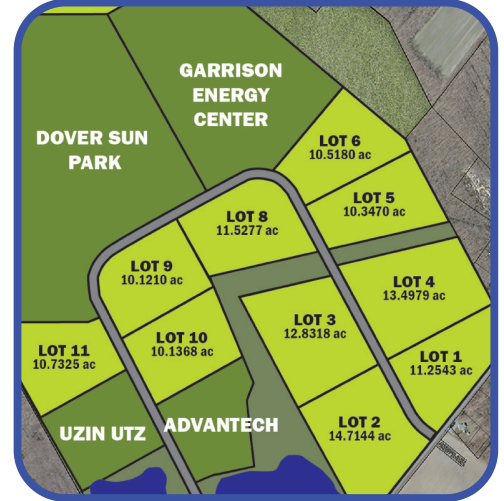

DOVER - Over 100 ac



CENTRAL DELAWARE BUSINESS PARK - CHESWOLD - 23 ac



SMYRNA - 206 ac



Located Within 4 Hours
of 4 Major Cities



- NO SALES TAX
- Shovel Ready Sites
- Low Land Cost
- Low Property Taxes

- No Red Tape
- Incentive Programs
- Access to Rail
- Skilled Workforce

Less Than 1 Days Drive of
60% of the US Population

for more info contact
lparkowski@ccded.com
302-678-3057

